

LEFT SIDE COMPARTMENTATION				
COMP.	DOORS	INSIDE DIMENSIONS	VOLUME	
L1	ROLL-UP	37"W X 56.75"H	43"W X 66"H X 27.14"D	42.2 CU. FT.
L2	ROLL-UP	57"W X 27.56"H	61.12"W X 36.12"H X 27.14"D	32.1 CU. FT.
L3	ROLL-UP	50"W X 56.75"H	53.12"W X 66"H X 27.14"D	52.5 CU. FT.
H1	LIFT-UP		162"L X 26"H X 21"W	51.1 CU. FT.

RIGHT SIDE COMPARTMENTATION				
COMP.	DOORS	INSIDE DIMENSIONS	VOLUME	
R1	ROLL-UP	37"W X 56.75"H	43"W X 66"H X 27.14"D (16.5" upper)	33.7 CU. FT.
R2	ROLL-UP	57"W X 27.56"H	61.12"W X 36.12"H X 16"D	18.8 CU. FT.
R3	ROLL-UP	50"W X 56.75"H	53.12"W X 66"H X 27.14"D (16.5" upper)	41.8 CU. FT.
H2	LIFT-UP		162"L X 26"H X 21"W	51.1 CU. FT.

REAR STEP COMPARTMENTS				
COMP.	DOORS	INSIDE DIMENSIONS	VOLUME	
A1	ROLL-UP	37.12"W X 31"H	30.12"D	27 CU. FT.

TOTAL STORAGE: 349.9 CU. FT.

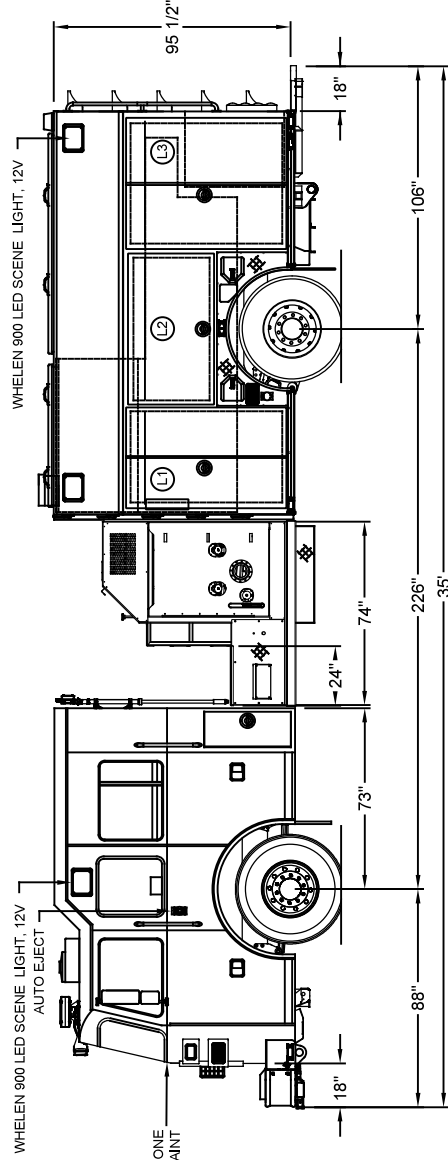
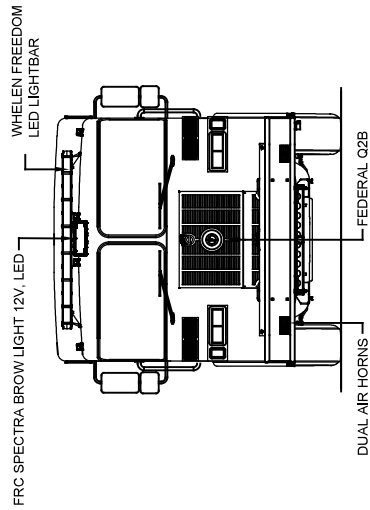
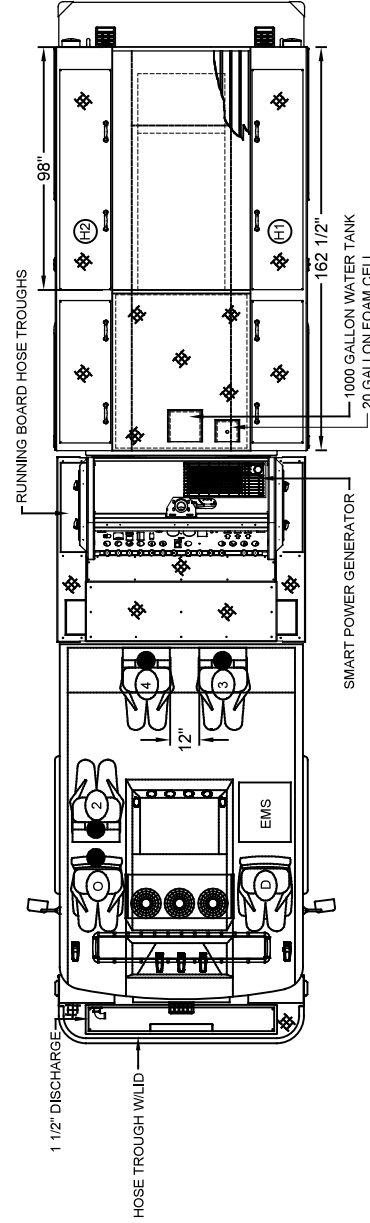

DIMENSIONS SHOWN ON THIS DRAWING ARE APPROXIMATE AND ARE SUBJECT TO MINOR DEVIATIONS DURING CONSTRUCTION. IN THE EVENT OF A DISCREPANCY BETWEEN THE SUTPHEN SPECIFICATIONS AND DRAWING, THE SUTPHEN SPECIFICATIONS SHALL PREVAIL. DRAWINGS FOR REFERENCE ONLY. SOME ITEMS PROPOSED MAY NOT BE SHOWN OR NOTED.

CUSTOMER APPROVAL

NAME: _____
TITLE: _____
DATE: _____

DRAWN BY: J.MORGAN
DATE: 08/31/18
MFG. FACILITY: DUBLIN

TURN/SIGNAL/CALL-OUTS
REV. A
DESCRIPTION: REV-A-SHOP-ORDER

DATE: 02/23/18

BY: JM

DATE: 02/23/18

DATE: 02/23/18

DATE: 02/23/18

DATE: 02/23/18

DATE: 02/23/18

DATE: 02/23/18

DATE: 02/23/18

DATE: 02/23/18

DATE: 02/23/18

DATE: 02/23/18

DATE: 02/23/18

DATE: 02/23/18

DATE: 02/23/18

DATE: 02/23/18

DATE: 02/23/18

DATE: 02/23/18

DATE: 02/23/18

DATE: 02/23/18

DATE: 02/23/18

DATE: 02/23/18

DATE: 02/23/18



LEADS FIRE DEPARTMENT
LEADS, AL

CUSTOM PUMPER - BODY

HS-0210

DATE: 02/23/18

DATE: 02/23/18

DATE: 02/23/18

DATE: 02/23/18

DATE: 02/23/18

DATE: 02/23/18

DATE: 02/23/18

DATE: 02/23/18

DATE: 02/23/18

DATE: 02/23/18

DATE: 02/23/18

DATE: 02/23/18

DATE: 02/23/18

DATE: 02/23/18

DATE: 02/23/18

DATE: 02/23/18

DATE: 02/23/18

DATE: 02/23/18

DATE: 02/23/18

DATE: 02/23/18

DATE: 02/23/18

DATE: 02/23/18

DATE: 02/23/18

DATE: 02/23/18

DATE: 02/23/18

DATE: 02/23/18

DATE: 02/23/18

DATE: 02/23/18